



0230-0316-0

PO BOX 4394
SANTA ROSA, CA
95402 USA

P (707) 525-9941
F (707) 575-7046
EMGPICKUPS.COM

INSTALLATION INFORMATION EMG MODEL: **B289 3-POSITION TOGGLE (IMPORT)**

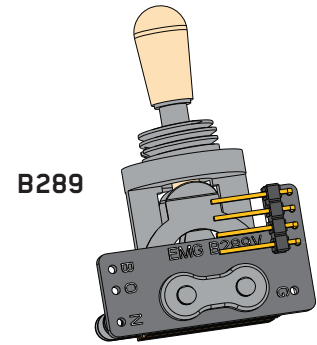

GENERAL INFORMATION:

The B289 is a 3-Position Selection Switch that incorporates EMG's Solderless Connectors. The B289 is a low-profile import model with a metric bushing. The switch uses EMG's "BNOG" connector arrangement and include a cable for easy connection to EMG's connection buss. The B289 includes both 17 inch and 6 inch cable lengths. Simply plug on the connectors and you're ready to go. There are some instances where your switch might work backwards, so see page two on how to reverse the selection if necessary. Ivory and Black switch toggle caps are available.

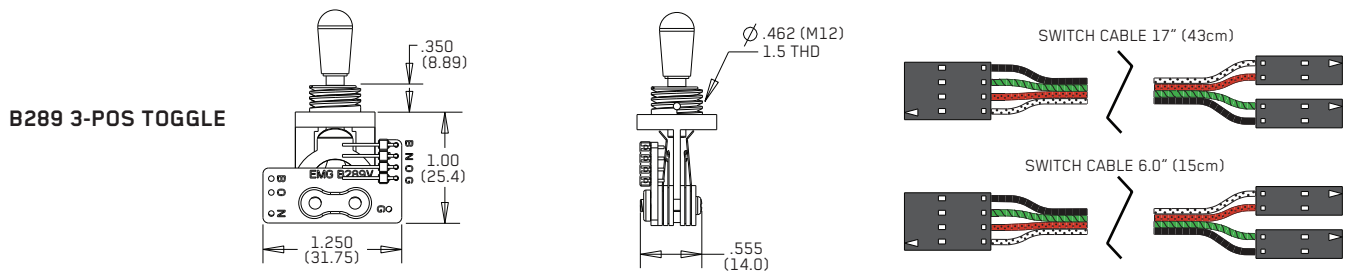

INSTALLATION:

B289 Selection Switch

The "BNOG" scheme is as follows:

- B= Bridge Pickup input (White wire)
- N= Neck Pickup input (Red wire)
- O= Output of Switch (Green wire)
- G= Ground (Black wire)

Install the 4 pin Connector housing on the switch as shown in the diagram to the right. Install the 2 separate 2 pin connectors on to the 4 pin connector between the black and red housings as shown. The black and green terminal blocks will not be used for the switch.

If the switch works **backwards?**

Simply reverse the connector that has the RED and WHITE wires and re-insert the plug as shown below.

Reverse this connector to make the switch work in the opposite direction

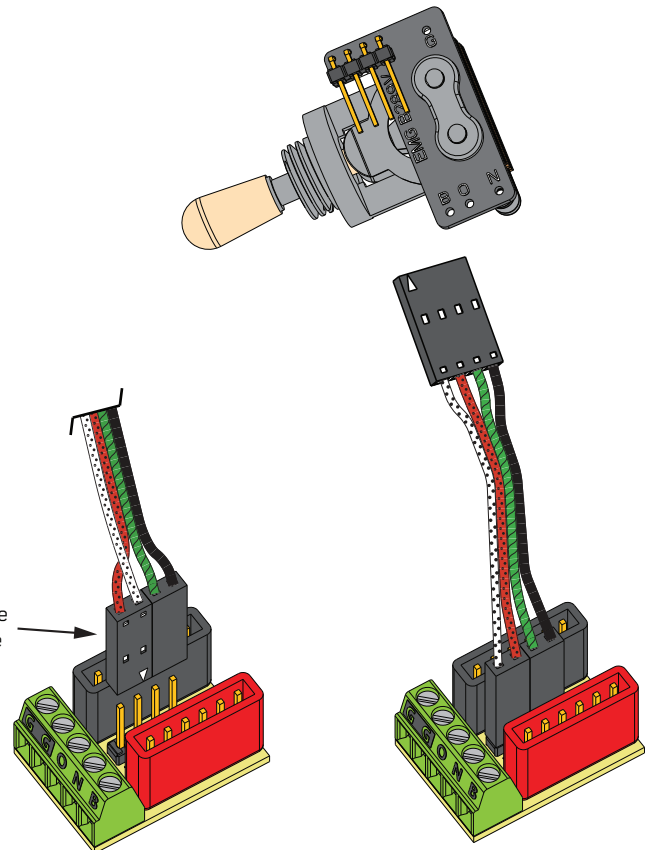

WARRANTY

All EMG Pickups and accessories are warranted for a period of two years. This warranty does not cover failure due to improper installation, abuse or damage. If upon examination the pickup is determined to be defective, a replacement will be made. Warranty replacement products are covered by this same warranty. This warranty covers only those pickups and accessories sold by authorized EMG Dealers. This warranty is not transferable.